

Akhisar Tepe Necropolis Archaeological Sites

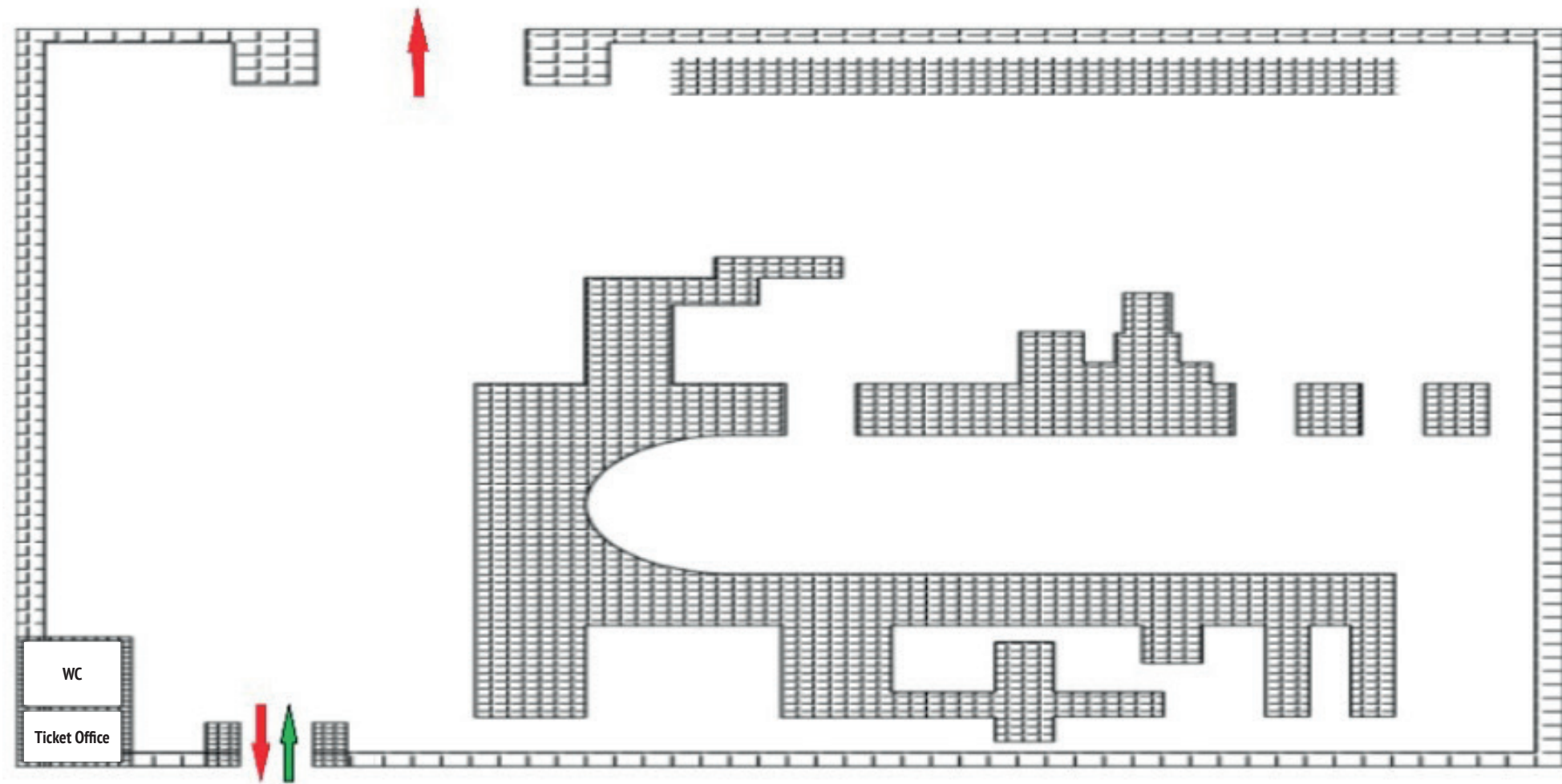

Visiting Hours

April 1 - October 1

Opening Time: 08:00  
Closing Time: 19:00  
Ticket Office Closing Time: 18:30

October 1 - April 1

Opening Time: 08:00  
Closing Time: 17:00  
Ticket Office Closing Time: 16:30

Open everyday.

Address: Hürriyet Mahallesi, 45200 • Phone: 0236 412 2301

Please visit the web site for up-to-date information.

[f TurkishMuseums](#)
[@officialturkishmuseums](#)
[t TurkishMuseums](#)
[v TurkishMuseums](#)
[@TurkishMuseums](#)

www.turkishmuseums.com



www.muze.gov.tr



# AKHISAR TEPE NECROPOLIS ARCHAEOLOGICAL SITES

TRACES OF THE ROMAN PERIOD

GENERAL DIRECTORATE FOR  
CULTURAL ASSETS AND MUSEUMS







Visible remains of the ancient city, located in the Akhisar district center of Manisa province, are in the Hill Necropolis Site in the district center. In the Tepe Necropolis, there are the remains of a north-south oriented basilica and an ancient colonnaded street that was built in many cities of Western Anatolia during the Roman Imperial Period. The remains of a courtyard dating to the 2nd-4th centuries and an apsidal structure dating to the 5-6th century were unearthed.



It is a monumental building called "basilica", dating from the 2nd to the 6th centuries CE. The inner part of the northern part of the rectangular planned building, whose walls are 4 to 5 m high, is in the form of an apse. The width of the building is approximately 10 meters, the preserved length is 43 meters, and there are square or rectangular rooms and spaces on the west.



It is dated between the 2nd and 4th centuries CE. It is a Roman street with columns extending in the north-south direction. They were placed on a foundation made of rubble stones with sand and lime mortar.